

# EVEROL WATERPROOF

## EXPLODED PARTS VIEW

## PARTS LIST

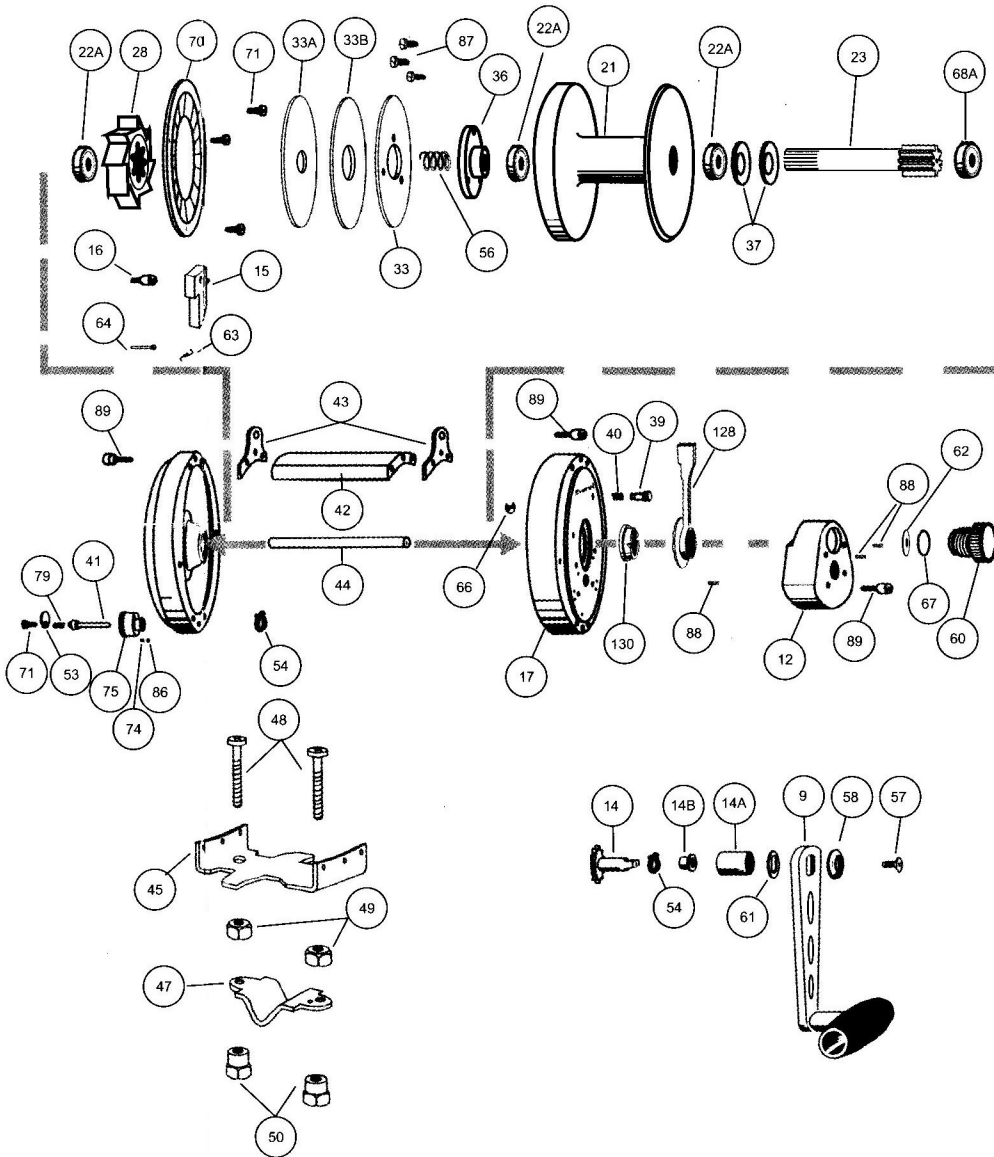

- 9 Handle assembly
- 12 Gear housing
- 14 Main gear
- 14a Main gear bearing
- 14b Main gear bearing
- 15 Anti reverse pawl
- 16 Pawl shaft
- 17 Right side plate
- 21 Spool
- 22a Ball bearing
- 23 Pinion gear
- 24 Left side plate
- 28 Antireverse
- 33 Liningless disk
- 33a Keying liningless disk
- 33b Double lined disk
- 36 Disk plate
- 37 Clutch taper spring
- 39 Strike and tree stop
- 40 Stop springs
- 41 Alarm striker
- 42 Upper frame post
- 43 Harness lug
- 44 Cylindrical frame post
- 45 Reel stand frame post
- 47 Rod clamp
- 48 Clamp washer
- 49 Nut
- 50 Collar nut
- 53 Alarm selector cover
- 54 Spring-lock ring
- 56 Pinion gear spring
- 57 Handle screw
- 58 Handle washer
- 60 Pre-set
- 61 Slotted washer
- 62 Washer
- 63 Pawl spring
- 64 Self tapping screw
- 66 Stop spring-lock ring
- 67 O ring
- 68a Ball bearing
- 70 Alarm striker plate
- 71 Striker plate screw
- 74 Spring
- 75 Alarm selector
- 79 Alarm striker spring
- 86 Ball
- 87 Screw
- 88 Centering pins
- 89 Allen screw
- 128 Clutch adjusting lever
- 130 Female screw